

1100 N

1000 E

1100 N

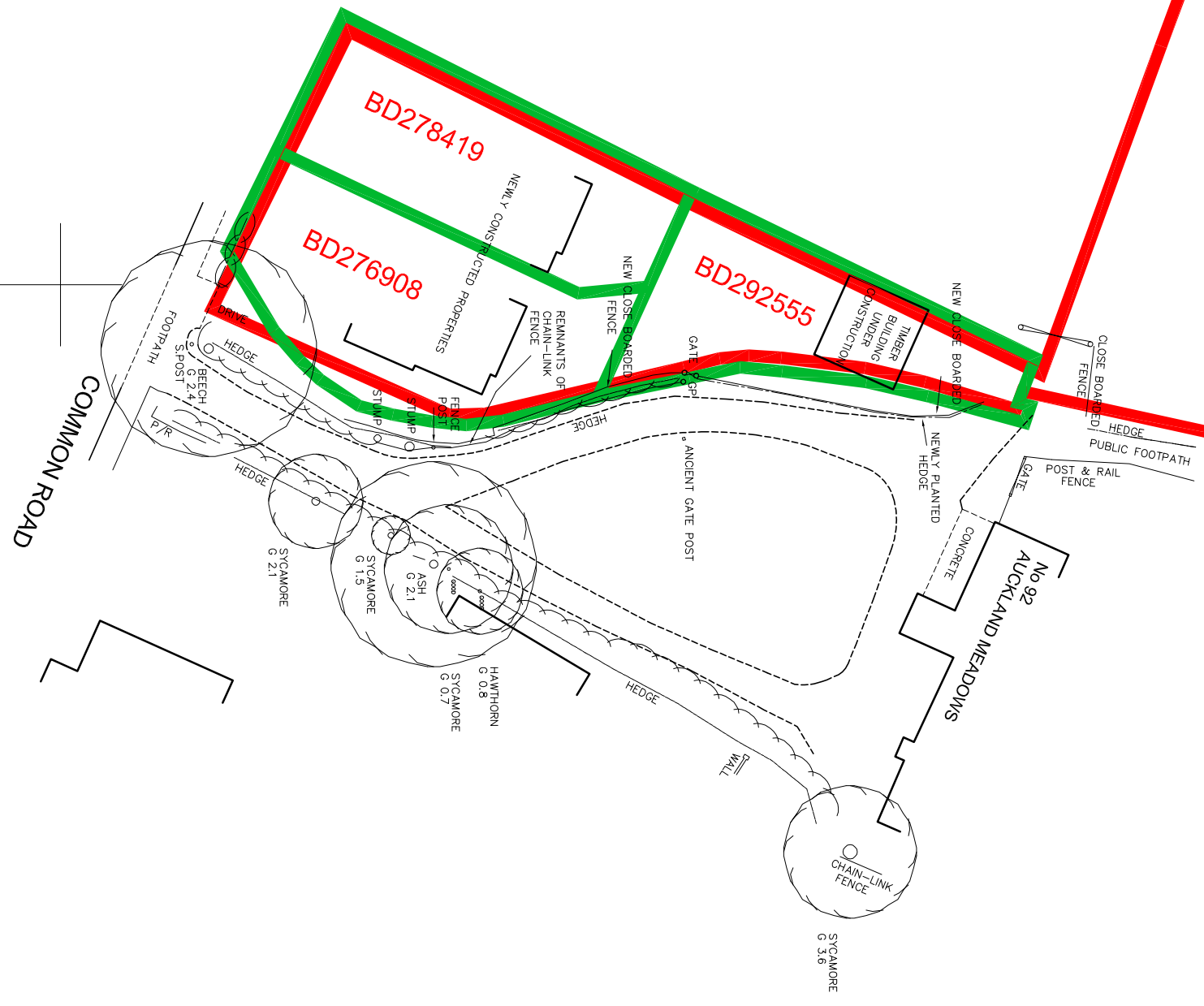

1000 N

1000 N

COMMON ROAD

- Notes :**
1. GRID IS OF LOCAL ORIGIN AND RELATED TO ORIGINAL SURVEY JOB NO 12188 DATED JUNE 2007.
  2. SCANNED IMAGE OF LAND REGISTRY TITLE DEED OVERLAIN BY DETAIL FIT ONLY.
  3. COLOURED LINES TAKEN FROM LAND REGISTRY PLAN BD228072

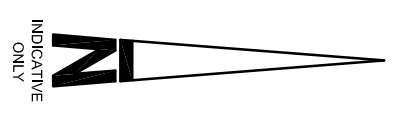

Revision	Description	Date
R3	Land Registry plans overlaid	Aug 2014
R2	Land Registry plans overlaid	Nov 2013
R1	Western boundary re-surveyed	Oct 2012

  
**40 years old in 2012**

Tel 01908 565651  
 Tel 01865 822312  
 Tel 01582 549500  
 Tel 02476 017060  
 Tel 01403 994695

www.mksurveyors.co.uk  
 Million Keyres  
 Oxford  
 Kidderminster  
 Nuneaton  
 Horsham

enquiries@mksurveyors.co.uk  
 oxford@mksurveyors.co.uk  
 kidderminster@mksurveyors.co.uk  
 nuneaton@mksurveyors.co.uk  
 horsham@mksurveyors.co.uk

**Mrs Elizabeth Tilbury**

**Auckland Meadows**  
**92 Common Road**  
**Kensworth**

Land Registry Title Plan Overlay

Scale	Sheet Size	Sheet Number	Date
1:500	A3	3	October 2012
Project Number:	Rev:	Surveyed By:	Approved By:
17554	3	HAC	DG